

W.I.C.C. Ltd  
 119 MULLER RD  
 PO Box 252  
 WASHINGTON IL 61571  
 (309)-444-4125  
 FAX (309)-444-3313

# CURRENT TRANSFORMER MODEL N

4.25" I.D.

PAGE No

REV 16MAR00

## TERMINAL OPTION

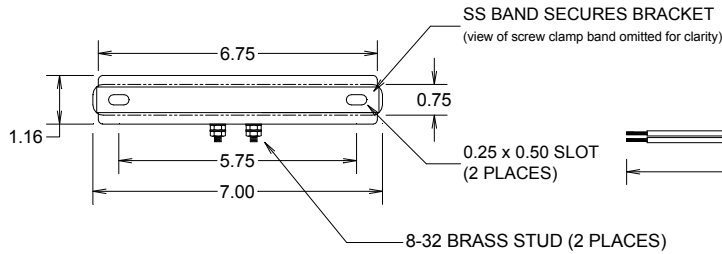

## LEAD WIRE OPTION

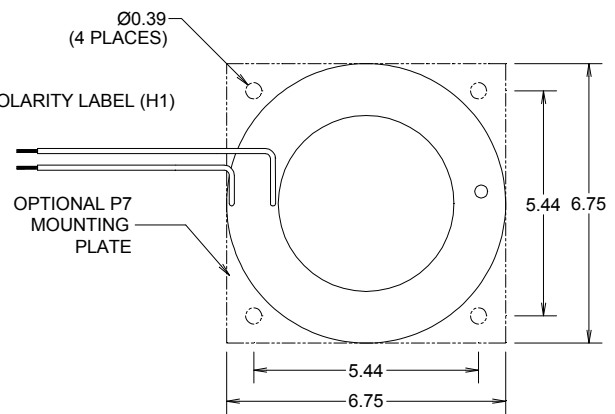
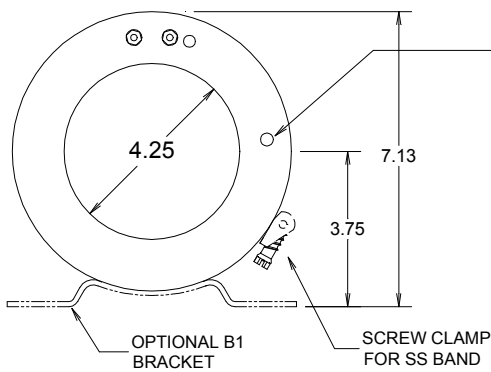
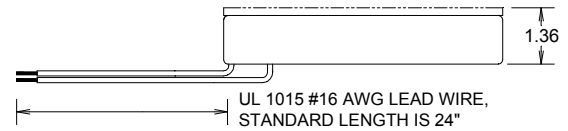

NOTES  
 1). ALL DIMENSIONS IN INCHES  
 2). ALL DIMENSIONS REF ONLY

## Specifications

- Secondary sources 5 amps AC at rated F.S. primary current
- Nominal operating frequency range is 50-400HZ
- Thermal rating factor is 1.33 @ 30C for all ratios
- Insulation voltage class is 0.6KV BIL 10KV
- For indoor applications only
- Conforms to provisions of IEEE C57.13 and IEC 44-1
- Enclosure is glass-filled nylon, color is black
- Optional bracket is aluminum

## Options, contact Factory for information

- UL and Canadian UL Recognized Component. File E100575
- 2.0, 5.0, and 10 VAC output at F.S. primary amperage. Other non-standard ratings also available.
- 1, 0.2, and 0.1 A output at F.S. primary amperage. Other non-standard ratings also available
- 8-32 Brass Stud Terminals or #16 AWG UL 1015 Lead Wires
- Custom lead wire lengths and types
- Thermal ratings above 1.33 for selected ratios.
- Center tap and custom multi tap winding arrangements

4.25" I.D.

CURRENT TRANSFORMER  
MODEL N



W.I.C.C. Ltd  
119 MULLER RD  
PO Box 252  
WASHINGTON IL 61571  
(309)-444-4125  
FAX (309)-444-3313

PAGE No

REV 16MAR00

TYPICAL EXCITATION CURVE for WICC MODEL N at 60HZ

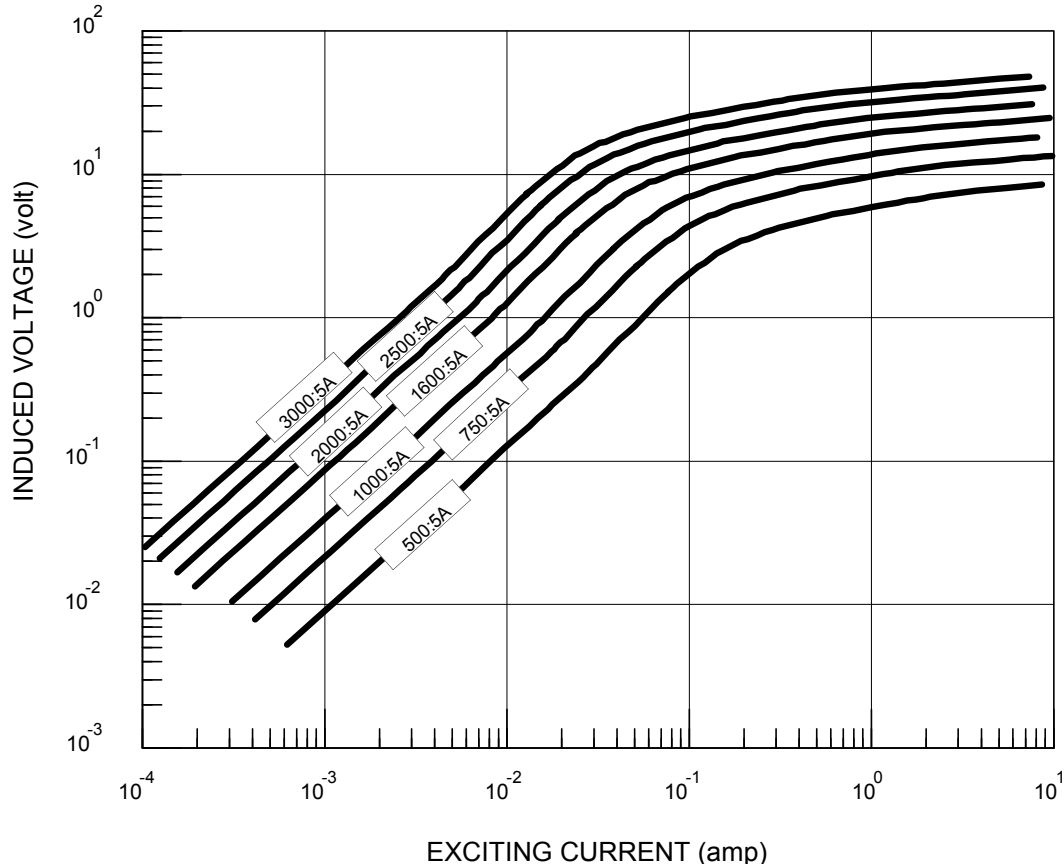

W.I.C.C. PART NUMBER *	RATIO	ACCURACY @ 60HZ, pf = 0.95		NOMINAL WINDING RESISTANCE (ohm)
		± %	BURDEN (VA)	
N-500-00-xxx	500:5A	1.0	3.0	0.14
N-750-00-xxx	750:5A	1.0	7.5	0.21
N-1000-00-xxx	1000:5A	1.0	15	0.28
N-1600-00-xxx	1600:5A	1.0	25	0.41
N-2000-00-xxx	2000:5A	1.0	40	0.52
N-2500-00-xxx	2500:5A	1.0	40	0.81
N-3000-00-xxx	3000:5A	1.0	50	1.0

\* "xxx" describes termination: "T" FOR BRASS STUDS, "Lyyy" FOR LEAD WIRES (Where "yyy" is the lead length in inches. For example, "L24" represents 24 inch long lead wires.)