

W.I.C.C. Ltd
 119 MULLER RD
 PO Box 252
 WASHINGTON IL 61571
 (309)-444-4125
 FAX (309)-444-3313

CURRENT TRANSFORMER MODEL C

2.88" I.D.

PAGE No

REV 24SEP99

TERMINAL OPTION

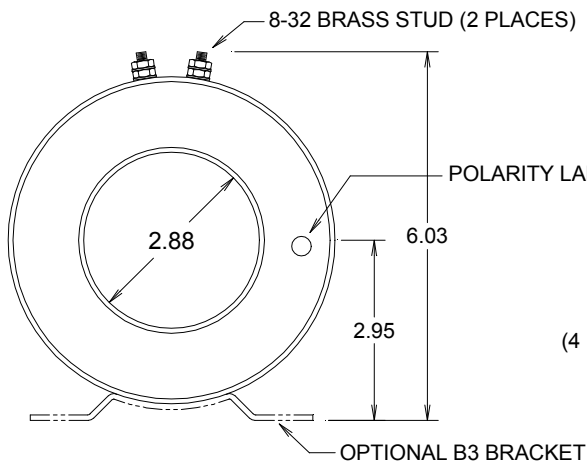
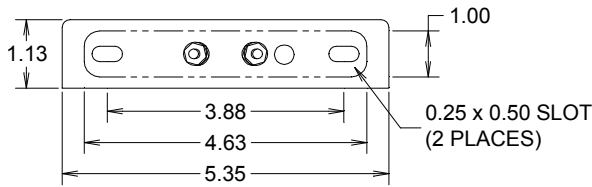

LEAD WIRE OPTION

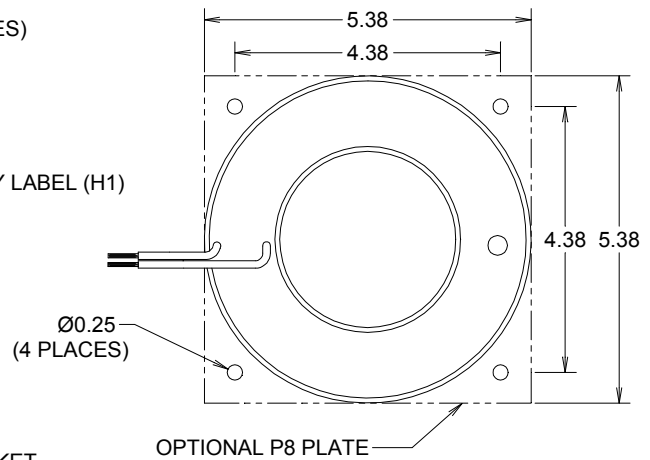
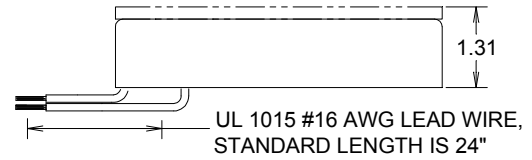

NOTES

- 1). ALL DIMENSIONS IN INCHES
- 2). ALL DIMENSIONS REF ONLY

Specifications

- Secondary sources 5 amps AC at rated F.S. primary current
- Nominal operating frequency range is 50-400HZ
- Thermal rating factor is 1.33 @ 30C for ratios up to 1600:5A, 1.15 @ 30C for ratios above 1600:5A
- Insulation voltage class is 0.6KV BIL 10KV
- For indoor applications only
- Conforms to provisions of IEEE C57.13 and IEC 44-1
- Enclosure is glass-filled nylon, color is black
- Optional plate is XX phenolic, optional bracket is aluminum

Options, contact Factory for information

- UL and Canadian UL Recognized Component. File E100575
- 2.0, 5.0, and 10 VAC output at F.S. primary amperage. Other non-standard ratings also available.
- 1, 0.2, and 0.1 A output at F.S. primary amperage. Other non-standard ratings also available
- 8-32 Brass Stud Terminals or #16 AWG UL 1015 Lead Wires
- Custom lead wire lengths and types
- Thermal ratings above 1.33 for selected ratios.
- Available with B1 and B31 brackets. See Bracket Data Section for dimensions.
- Available with B54 bracket when ratio is above 500:5A. See Bracket Data Section for dimensions.
- Center tap and custom multi tap winding arrangements

2.88" I.D.

CURRENT TRANSFORMER
MODEL C

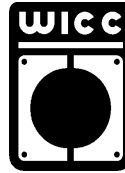

W.I.C.C. Ltd
119 MULLER RD
PO Box 252
WASHINGTON IL 61571
(309)-444-4125
FAX (309)-444-3313

PAGE No

REV 29OCT99

TYPICAL EXCITATION CURVE for WICC MODEL C at 60HZ

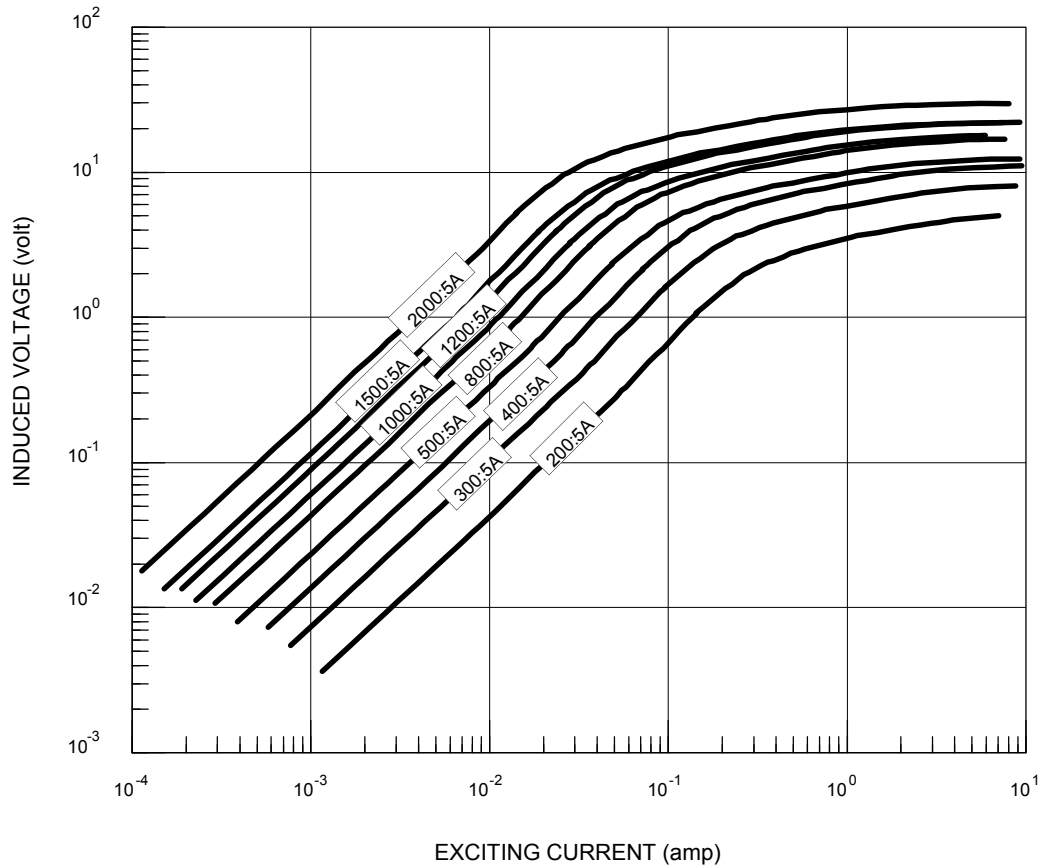

W.I.C.C. PART NUMBER *	RATIO	ACCURACY @ 60HZ, pf = 0.95		NOMINAL WINDING RESISTANCE (ohm)
		± %	BURDEN (VA)	
C-200-00-xxx	200:5A	1.5	2.0	0.06
C-250-00-xxx	250:5A	1.0	2.0	0.08
C-300-00-xxx	300:5A	1.0	3.0	0.09
C-400-00-xxx	400:5A	1.0	7.0	0.12
C-500-00-xxx	500:5A	1.0	10	0.14
C-600-00-xxx	600:5A	1.0	12	0.15
C-800-00-xxx	800:5A	1.0	20	0.20
C-1000-00-xxx	1000:5A	1.0	25	0.25
C-1200-00-xxx	1200:5A	1.0	30	0.30
C-1500-00-xxx	1500:5A	1.0	35	0.40
C-1600-00-xxx	1600:5A	1.0	30	0.43
C-1800-00-xxx	1800:5A	1.0	30	0.50
C-2000-00-xxx	2000:5A	1.0	35	0.60

* "xxx" describes termination: "T" FOR BRASS STUDS, "Lyyy" FOR LEAD WIRES (Where "yyy" is the lead length in inches. For example, "L24" represents 24 inch long lead wires.)