

W.I.C.C. Ltd
 119 MULLER RD
 PO Box 252
 WASHINGTON IL 61571
 (309)-444-4125
 FAX (309)-444-3313

CURRENT TRANSFORMER MODEL L595

0.75" I.D.

PAGE No

REV 03/26/99

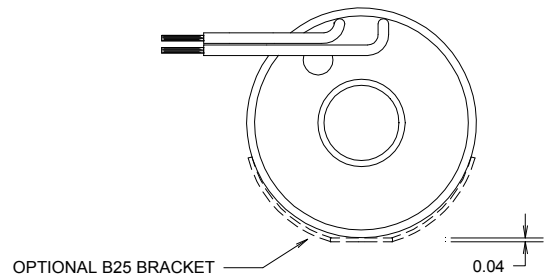
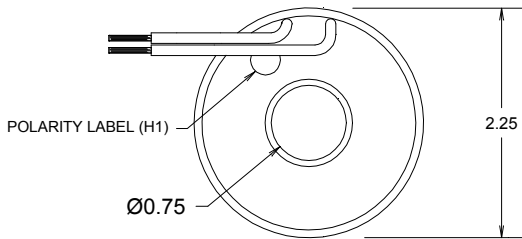
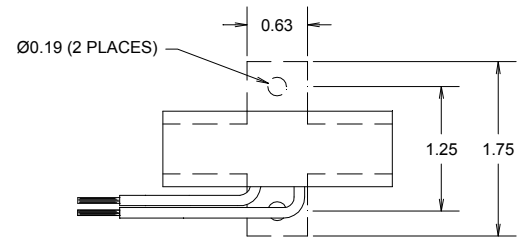
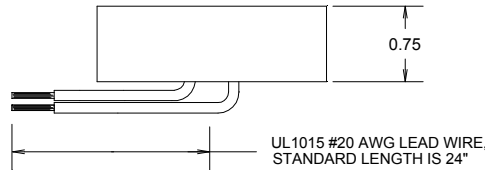

NOTES:
 1) ALL DIMENSIONS IN INCHES
 2) ALL DIMENSIONS REF ONLY

Specifications

- Secondary sources 0.1 amps AC at rated F.S. primary current
- Nominal operating frequency range is 50-400HZ
- Thermal rating factor is 1.33 @ 30C for all ratios
- Insulation voltage class is 0.6KV BIL 10KV
- For indoor applications only
- Conforms to provisions of IEEE C57.13 and IEC 44-1
- Enclosure is glass-filled nylon, color is black
- Optional bracket is steel

Options, contact Factory for information

- UL and Canadian UL Recognized Component. File E100575
- 2.0, 5.0, and 10 VAC output at F.S. primary amperage. Other non-standard ratings also available.
- 1 and 0.2 A output at F.S. primary amperage. Other non-standard ratings also available
- Custom lead wire lengths and types
- Thermal ratings above 1.33 for selected ratios.

0.75" I.D.

CURRENT TRANSFORMER
MODEL L595

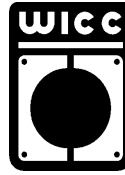

W.I.C.C. Ltd
 119 MULLER RD
 PO Box 252
 WASHINGTON IL 61571
 (309)-444-4125
 FAX (309)-444-3313

PAGE No

REV 03/26/99

TYPICAL EXCITATION CURVE for WICC MODEL L595 at 60HZ

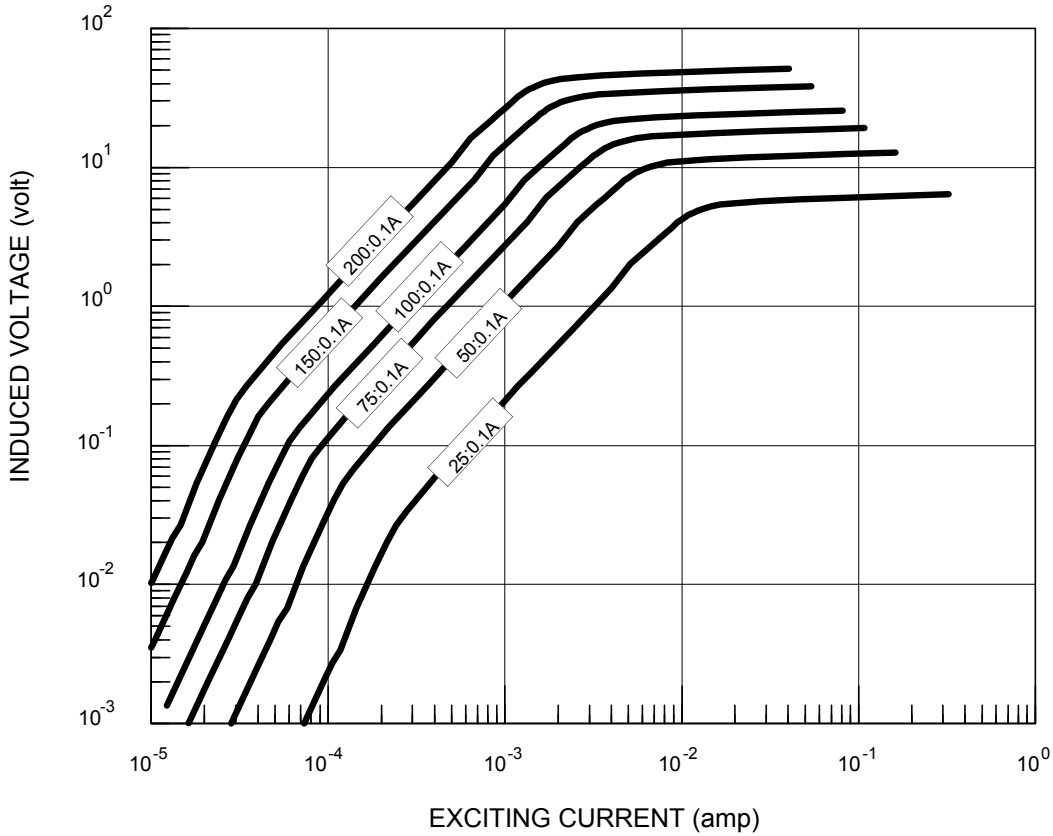

W.I.C.C. PART NUMBER *	RATIO	ACCURACY @ 60HZ, pf = 0.95		NOMINAL WINDING RESISTANCE (ohm)
		± %	BURDEN (ohm)	
L595-025-02-Lxxx	25:0.1A	2.0	5	2.0
L595-050-02-Lxxx	50:0.1A	1.0	10	6.2
L595-075-02-Lxxx	75:0.1A	1.0	25	9.6
L595-100-02-Lxxx	100:0.1A	1.0	50	20
L595-150-02-Lxxx	150:0.1A	1.0	125	32
L595-200-02-Lxxx	200:0.1A	1.0	225	45

* "Lxxx" describes LEAD WIRE termination where "xxx" is the lead length in inches. For example, "L24" represents 24 inch long lead wires.