

W.I.C.C. Ltd
119 MULLER RD
PO Box 252
WASHINGTON IL 61571
(309)-444-4125
FAX (309)-444-3313

CURRENT TRANSFORMER MODEL AA

2.25" I.D.

PAGE No 1-4

REV 14DEC00

TERMINAL OPTION

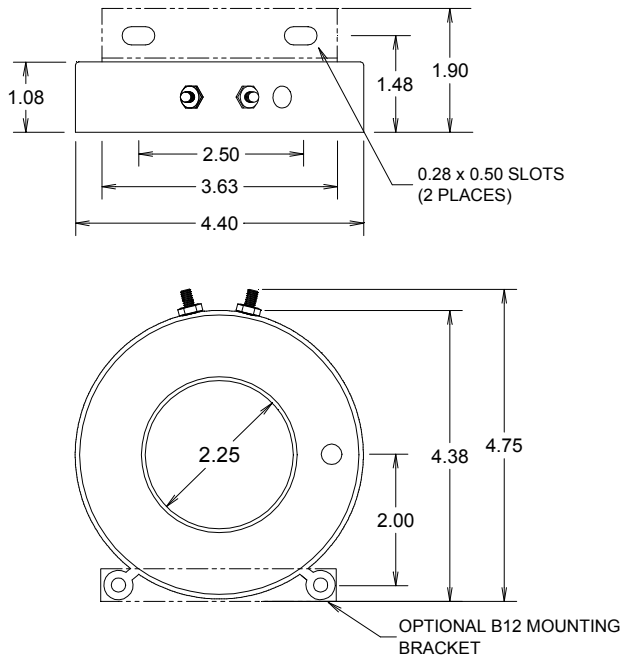

NOTE:
1) ALL DIMENSIONS IN INCHES
2) ALL DIMENSIONS REF ONLY

LEAD WIRE OPTION

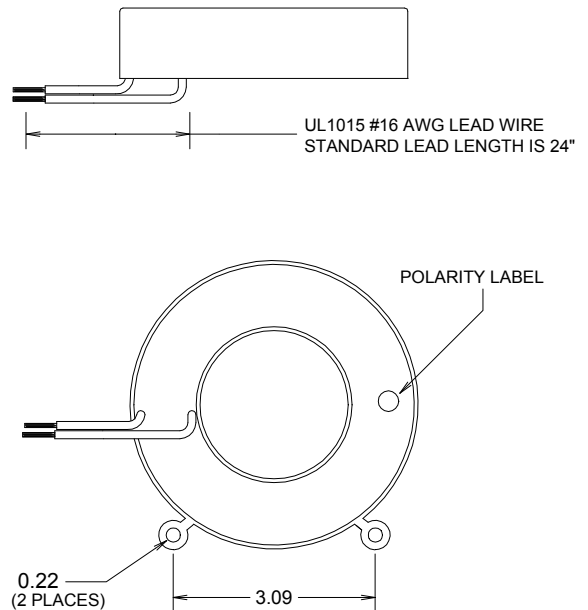

Specifications

- Secondary sources 5 amps AC at rated F.S. primary current
- Nominal operating frequency range is 50-400HZ
- Thermal rating factor is 1.33 @ 30C for ratios up to 1500:5A, 1.15 @ 30C for ratios above 1500:5A
- Insulation voltage class is 0.6KV BIL 10KV
- For indoor applications only
- Reference documents IEEE C57.13, UL 1244, and IEC 44-1
- Enclosure is glass-filled nylon, color is black
- Optional bracket is steel with black oxide finish

Options, contact Factory for information

- UL and Canadian UL Recognized Component. File E100575
- 2.0, 5.0, and 10 VAC output at F.S. primary amperage. Other non-standard ratings also available
- 1.0, 0.2, and 0.1 A output at F.S. primary amperage. Other non-standard ratings also available
- 8-32 Brass Stud Terminals or #16 AWG UL 1015 Lead Wires
- Custom lead wire lengths and types
- Thermal ratings above 1.33 for selected ratios
- Center tap and custom multi tap winding arrangements

2.25" I.D.

PAGE No 1-5

REV 14DEC00

CURRENT TRANSFORMER MODEL AA

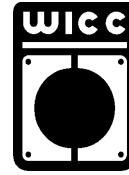

W.I.C.C. Ltd
119 MULLER RD
PO Box 252
WASHINGTON IL 61571
(309)-444-4125
FAX (309)-444-3313

TYPICAL EXCITATION CURVE FOR WICC MODEL AA at 60HZ

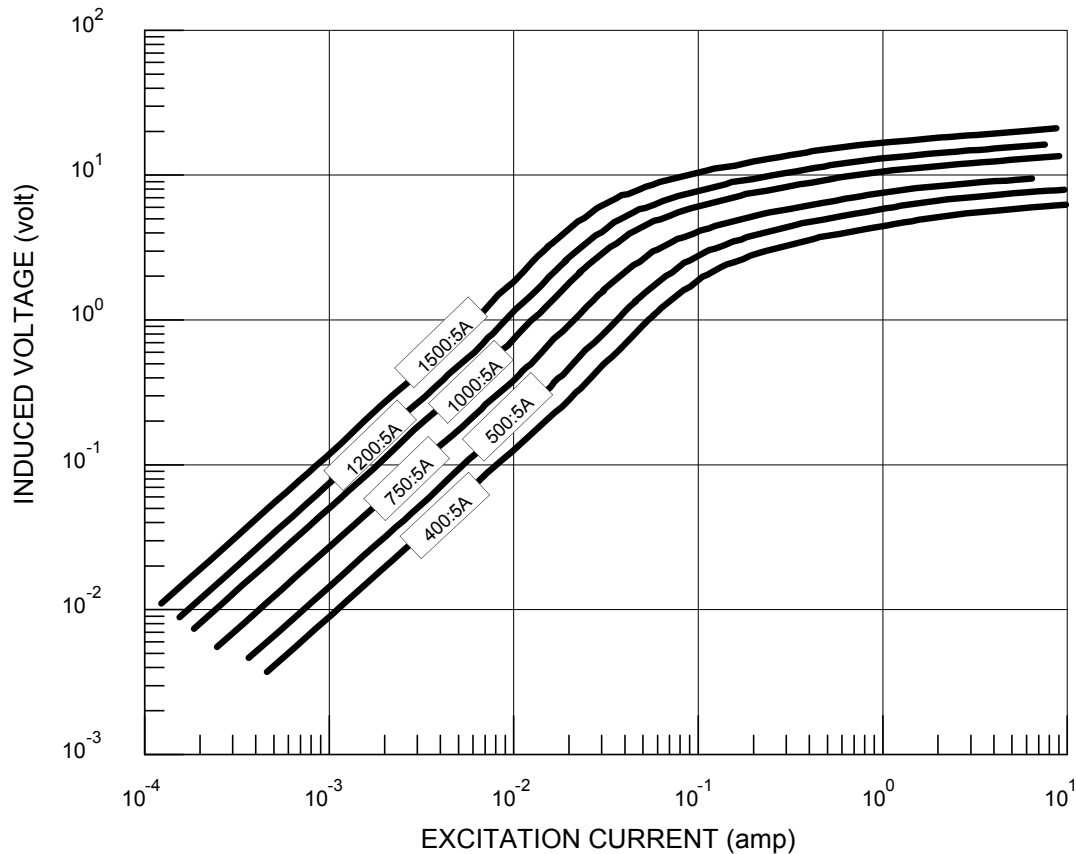

| W.I.C.C. PART NUMBER * | RATIO | ACCURACY @ 60HZ, pf = 0.95 | | NOMINAL WINDING RESISTANCE (ohm) |
|---------------------------|---------|----------------------------|-------------|-------------------------------------|
| | | ± % | BURDEN (VA) | |
| AA-200-00-xxx | 200:5A | 1.0 | 2.0 | 0.02 |
| AA-250-00-xxx | 250:5A | 1.0 | 3.0 | 0.05 |
| AA-300-00-xxx | 300:5A | 1.0 | 4.5 | 0.06 |
| AA-400-00-xxx | 400:5A | 1.0 | 4.0 | 0.11 |
| AA-500-00-xxx | 500:5A | 1.0 | 6.5 | 0.13 |
| AA-600-00-xxx | 600:5A | 1.0 | 7.5 | 0.15 |
| AA-750-00-xxx | 750:5A | 1.0 | 12.5 | 0.18 |
| AA-800-00-xxx | 800:5A | 1.0 | 12.5 | 0.20 |
| AA-1000-00-xxx | 1000:5A | 1.0 | 17.5 | 0.25 |
| AA-1200-00-xxx | 1200:5A | 1.0 | 22 | 0.30 |
| AA-1500-00-xxx | 1500:5A | 1.0 | 30 | 0.39 |

* "xxx" describes termination: "T" FOR BRASS STUDS, "Lyyy" FOR LEAD WIRES (Where "yyy" is the lead length in inches. For example, "L24" represents 24 inch long lead wires.)